

# C-350

## SERVICE MANUAL

OCT 29 1984

AEP Model  
UK Model  
E Model

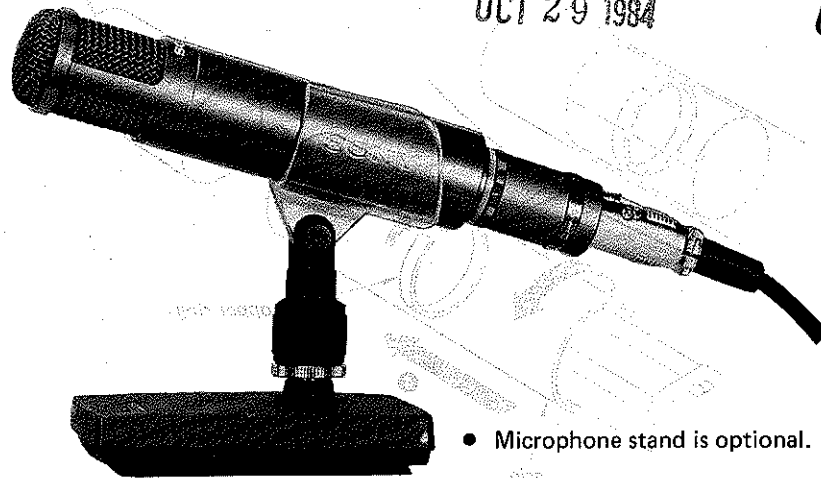

• Microphone stand is optional.

### SPECIFICATIONS

#### General

Type Condenser microphone  
Battery IEC designation R6 (size AA) battery  
Microphone output connector Cannon XLR-3-12C type

Dimensions 36 mm dia. x 205 mm  
(1<sup>7</sup>/<sub>16</sub> inches dia. x 8<sup>1</sup>/<sub>8</sub> inches)

Weight Approx. 330 g (11.6 oz) not incl. battery  
Approx. 350 g (12.3 oz) incl. battery

Finish Metallic silver gray finish

#### Performance

Frequency response 20-20,000 Hz  
Directivity Cardioid  
Output impedance 200 ohms  $\pm$ 20%, balanced  
Output level (deviation  $\pm$ 2 dB)

Open circuit voltage: -72 dB (0.25 mV)  
(0 dB = 1 V/ $\mu$ bar, 1,000 Hz)  
(1  $\mu$ bar = 0.1 Pascal)  
Effective output level: -51 dBm  
(0 dBm = 1 mW/10  $\mu$ bar, 1,000 Hz)  
Recommended load impedance is more than 3 kilohms.

Power requirements Battery operation  
Normal operating voltage: 1.5 V  
Minimum operating voltage: Approx. 1.1 V  
Current drain: Less than 7.0 mA (at normal operating voltage)  
Battery life: Approx. 100 hours with Sony SUM-3(NS) New Super battery  
External power operation DC 48 V

#### Noise level

Signal-to-noise ratio (with the use on the internal battery)

More than 52 dB (1,000 Hz, 1  $\mu$ bar)

Inherent noise (with the use on the internal battery)

Less than 22 dB SPL (0 dB SPL =  $2 \times 10^{-4}$   $\mu$ bar)

Wind noise\*<sup>1</sup>

Less than 50 dB SPL (with the supplied wind screen)

Induction noise from external magnetic field\*<sup>2</sup>

5 dB SPL/m gauss

\*<sup>1</sup> Wind noise is the value measured by applying a wind velocity of 2 m/sec. (6.6 ft./sec.) from all directions to the microphone. The mean value is taken and converted to the equivalent input sound level. 0 dB =  $2 \times 10^{-4}$   $\mu$ bar

\*<sup>2</sup> The external magnetic field induction noise is measured with the microphone placed in an alternating magnetic field of 50 Hz, 1 milligauss. The maximum noise value is taken and converted to the equivalent input sound level. 0 dB =  $2 \times 10^{-4}$   $\mu$ bar

Maximum sound pressure input level

More than 138 dB SPL (at 1,000 Hz, 1% distortion)

Dynamic range

More than 116 dB (with the use on internal battery)

Environmental temperatures

-20°C to +60°C (-4°F to +140°F) for storage

0°C to 60°C (+32°F to +140°F) for operation

## CONDENSER MICROPHONE

# SONY®



ACC

**1. GRIP REMOVAL**

**Note:** Follow the disassembly procedure in the numerical order given.

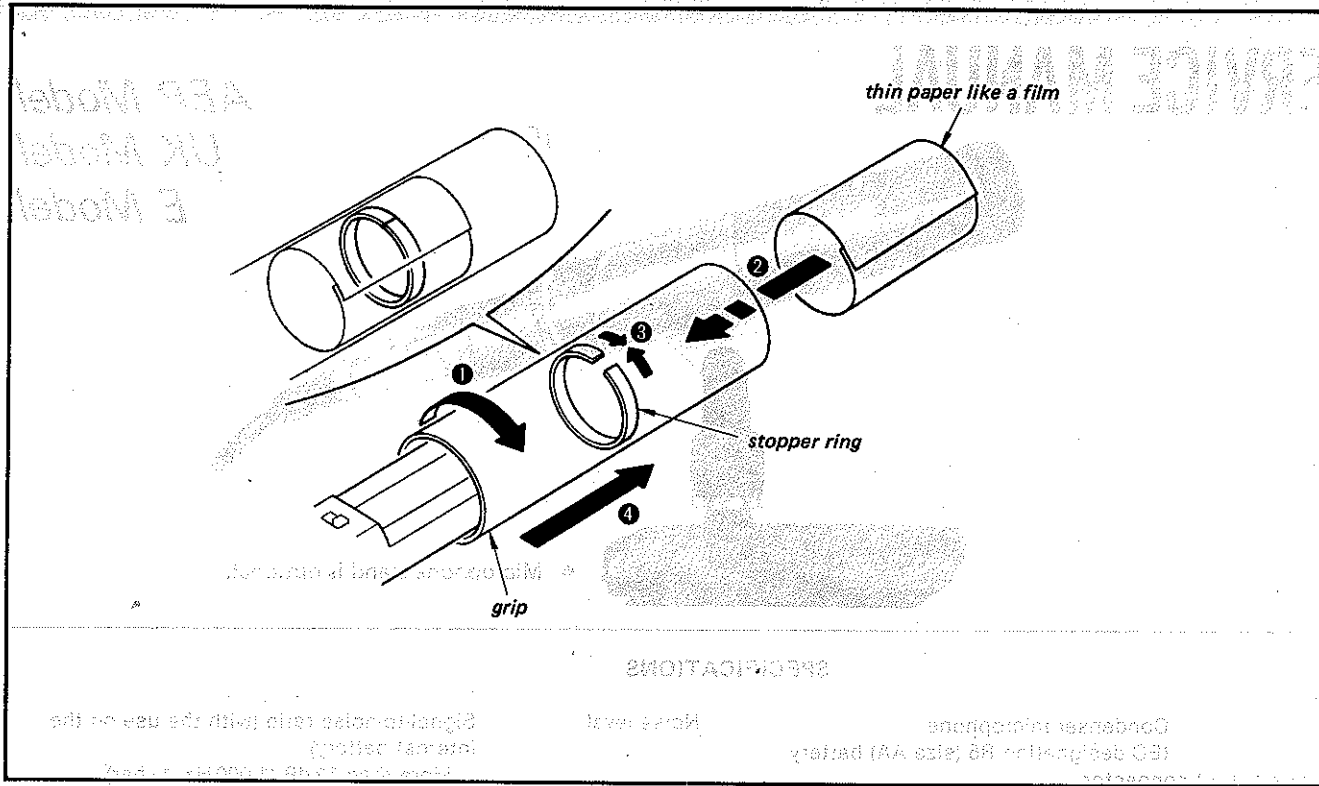

**2. NOTE ON PLUG AND CONNECTOR REPLACEMENT**

(The plug is supplied separately from the cord.)  
The part number of plug is 1-506-420-00. Refer to page 5.)

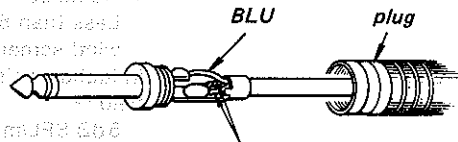

**Solder white and shielded wires together.**

(The connector is supplied separately from the cord.)  
The part number of connector is 1-508-083-00. Refer to page 5.)

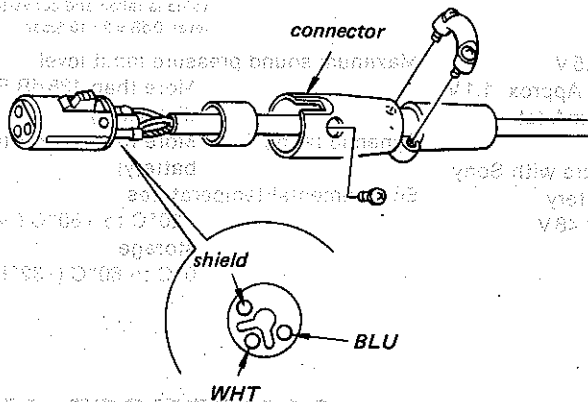

3. MOUNTING DIAGRAM

— Conductor Side —

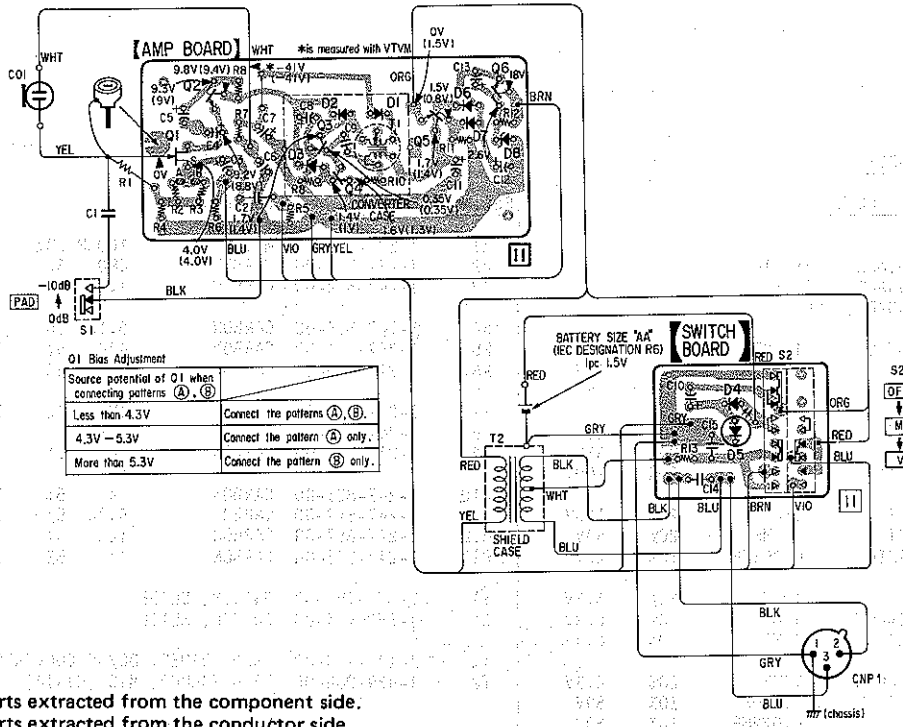

Note:

- — parts extracted from the component side.
- — parts extracted from the conductor side.

4. SCHEMATIC DIAGRAM

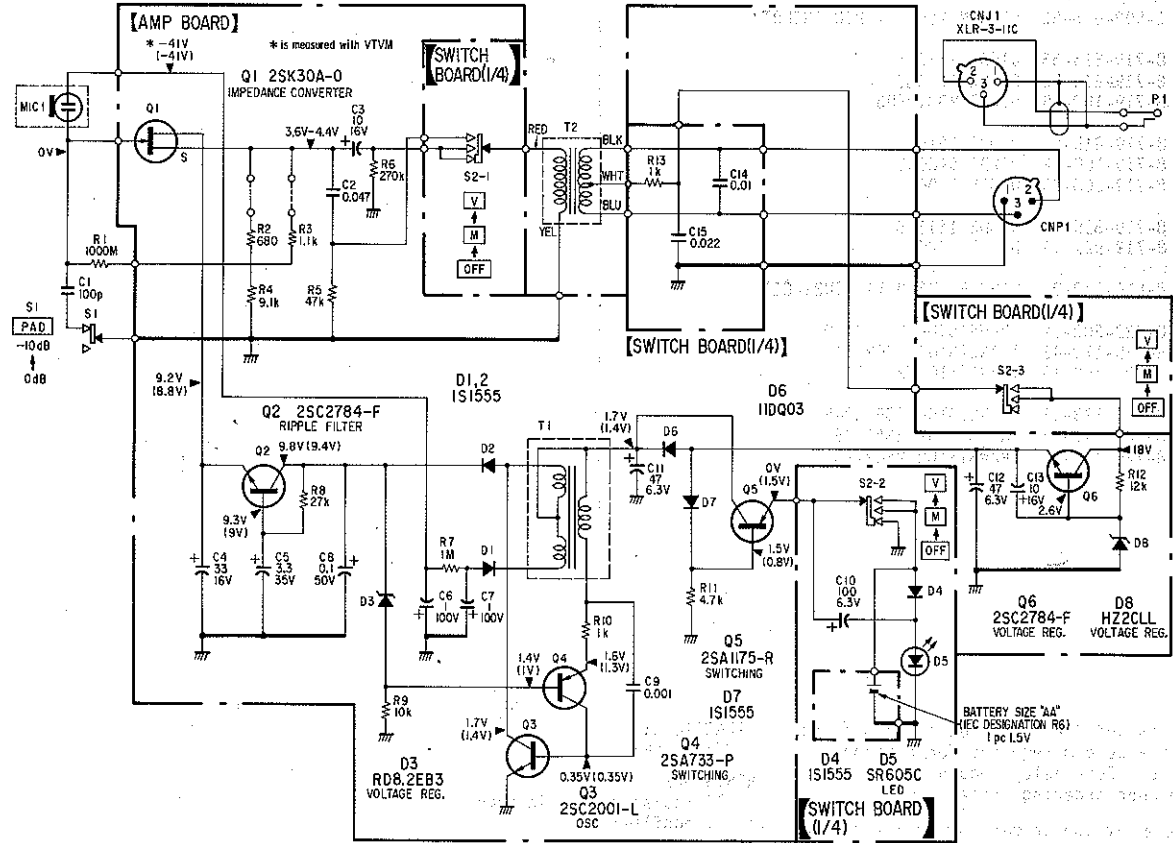

Note:

- All capacitors are in  $\mu\text{F}$  unless otherwise noted.  $\text{pF}$ :  $\mu\text{M}$ F 50VV or less are not indicated except for electrolytics and tantalums.
- All resistors are in  $\Omega$  and  $\frac{1}{4}\text{W}$  or less unless otherwise specified.
- Voltages are dc with respect to ground unless otherwise noted.
- Readings are taken under no-signal conditions with a VOM (50  $\text{k}\Omega/\text{V}$ ). ( ): measured with dry battery. no mark: measured with external power supply.
- Voltage variations may be noted due to normal production tolerances.

5. EXPLODED VIEW

1  
2  
3  
4  
5  
6  
7  
8

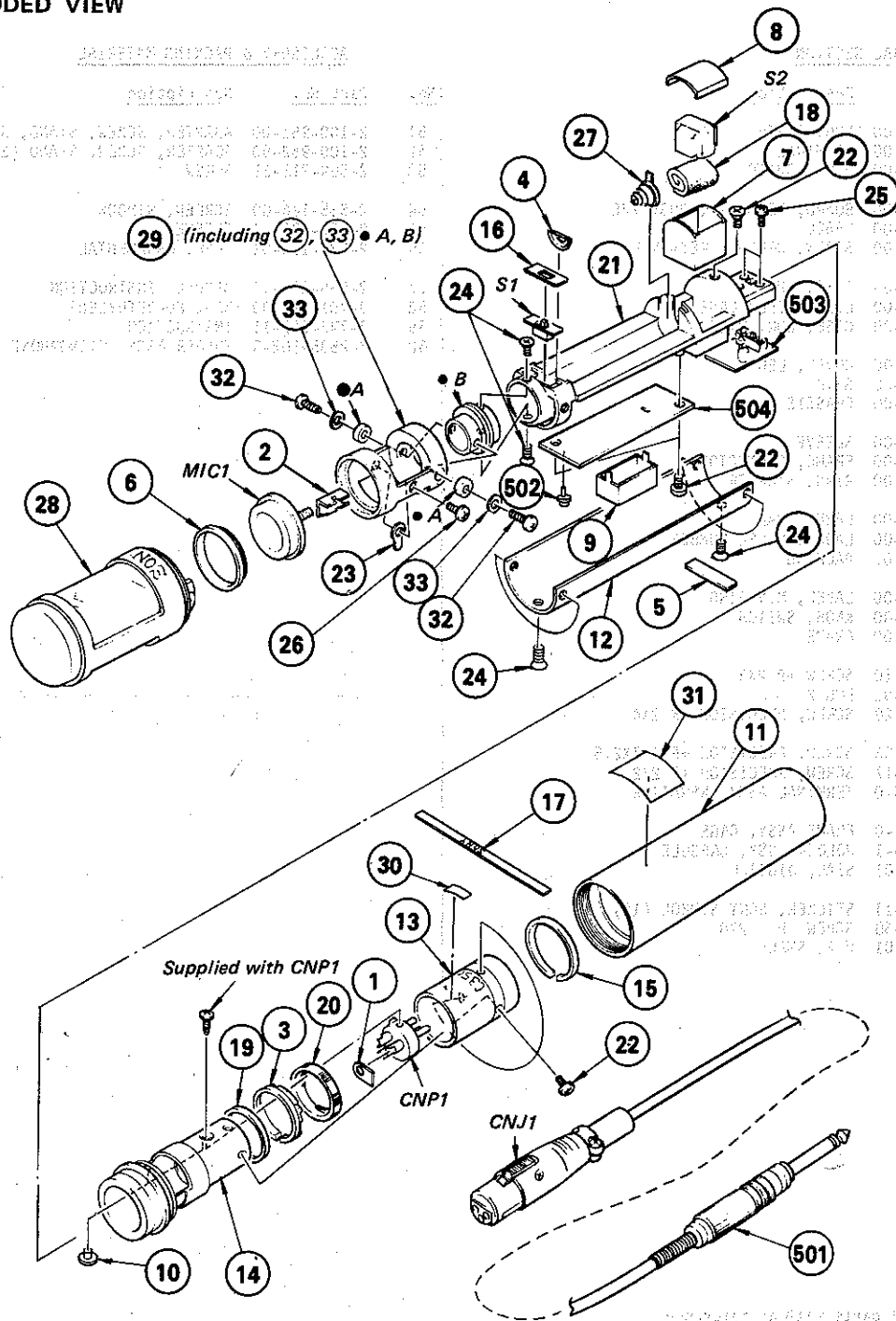

• Semiconductor Lead Layouts

<p>1S1555 HZ2CLL RD8.2EB3 11DQ03</p> <p>cathode anode</p>	<p>2SK30A-0</p> <p>S G D</p>	<p>2SA1175 2SC2784</p> <p>letter side</p> <p>E C B</p>	<p>2SA733-P 2SC2001</p> <p>E C B</p>	<p>SR605C</p> <p>long short anode cathode</p>
---	------------------------------	--	--	---

6 PARTS LIST

EXPLODED VIEW

GENERAL SECTION

ACCESSORY & PACKING MATERIAL

No.	Part No.	Description
1	2-506-805-00	LUG, EARTH
2	*2-509-609-00	TERMINAL
3	2-513-914-00	RING, SWITCH
4	2-520-113-00	BOARD, TERMINAL, POSITIVE
5	2-520-118-00	LABEL
6	*2-535-108-00	SCREW, CAPSULE RETAINER
7	*2-535-111-00	CASE, SHIELD
8	*2-535-112-00	LID, SHIELD CASE
9	*2-535-113-00	CASE, CONVERTER
10	*2-535-114-00	COVER, LED
11	2-535-115-00	GRIP
12	*2-535-116-00	CHASSIS
13	2-535-117-00	SLEEVE
14	*2-535-118-00	FRAME, CONNECTOR
15	2-535-119-00	RING, STOPPER
16	2-535-120-00	LABEL, PAD
17	2-535-121-00	LABEL, MODEL NUMBER
18	*2-535-123-00	PACKING
19	2-535-124-00	LABEL, M.V. RING
20	2-535-125-00	KNOB, SWITCH
21	*2-535-128-00	FRAME
22	7-621-255-10	SCREW +P 2X3
23	7-623-505-01	LUG 2
24	7-627-452-28	SCREW, PRECISION +K 2X4
25	7-627-552-08	SCREW, PRECISION +P 1.7X2.5
26	7-627-553-17	SCREW, PRECISION +P 2X2
27	X-2523-006-0	TERMINAL ASSY, NEGATIVE
28	X-2535-101-0	FRAME ASSY, CAGE
29	X-2535-103-1	HOLDER ASSY, CAPSULE
30	2-535-134-01	SEAL, DIGITAL
31	3-703-708-11	STICKER, SONY SYMBOL (18)
32	7-621-255-50	SCREW +P 2X8
33	7-688-001-01	W 2, SMALL

No.	Part No.	Description
51	2-100-951-00	ADAPTER, SCREW, STAND, SAD-34
52	2-100-952-00	ADAPTER, SCREW, STAND (SAD-35)
53	2-509-712-21	SCREW
54	2-535-126-00	SCREEN, WINDOW
55	2-535-130-01	SLEEVE
56	2-535-133-01	CASE, ORNAMENTAL
57	2-599-225-11	MANUAL, INSTRUCTION
58	3-701-622-00	BAG, POLYETHYLENE
59	3-793-557-11	INSTRUCTION
60	X-2535-102-0	HOLDER ASSY, MICROPHONE

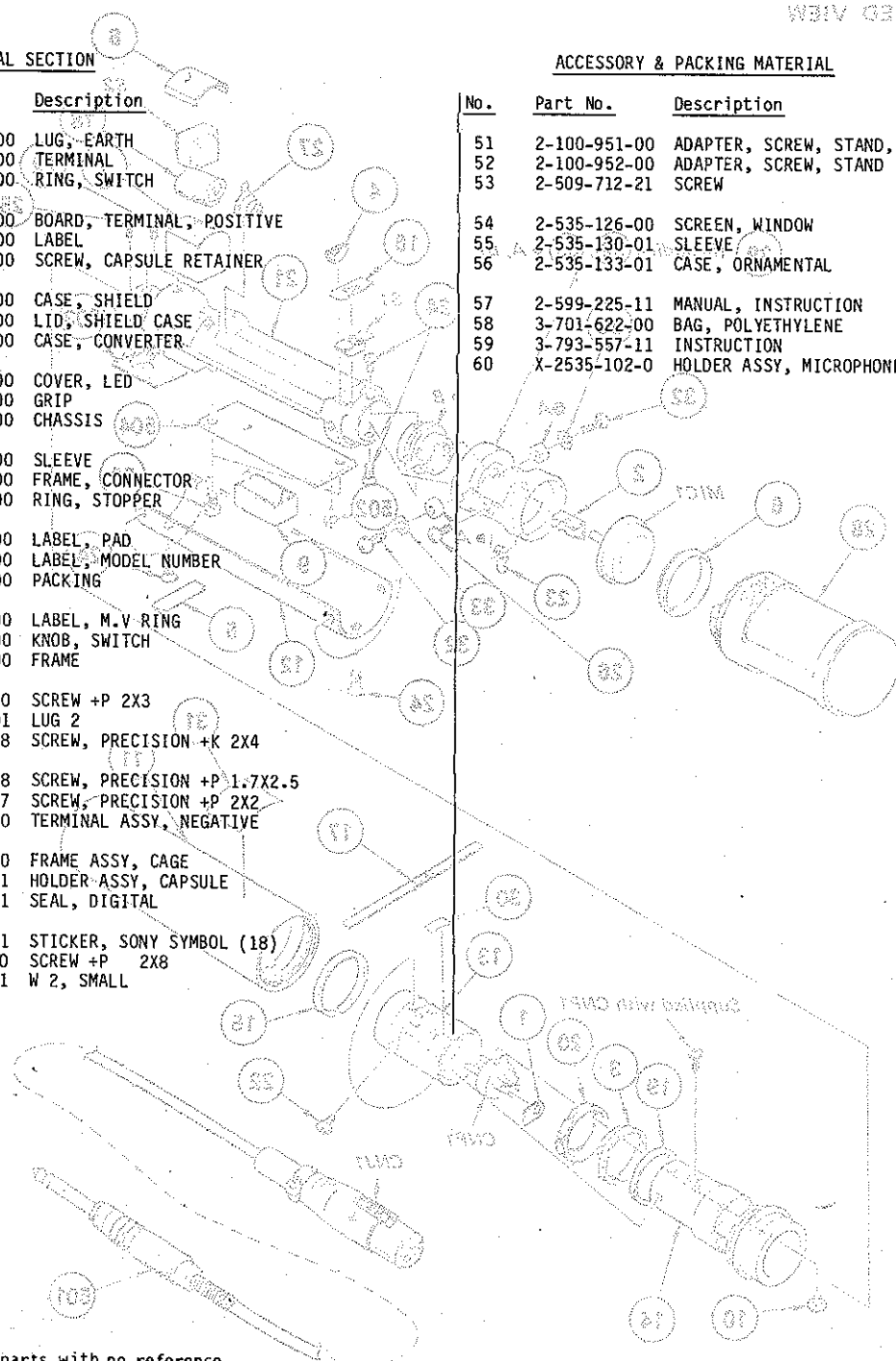

NOTE:

The mechanical parts with no reference number in the exploded views are not supplied.

Items marked with \* are not stocked since they are seldom required for routine service. Some delay should be anticipated when ordering these items.

--	--	--	--

## SUPPLEMENT

AEP Model  
UK Model  
E Model

File this supplement with the Service Manual.

DEC 12 1986

No. 1  
November, 1986

**Subject: Diode (D9) is added.**

- The following diode is added.

Ref. No.	Part No.	Description
D9	8-719-913-44	DIODE ERA82-004

- Applicable Lot No.: 4,060 and later

Lot No. is given on the label of No. ⑤ shown below.

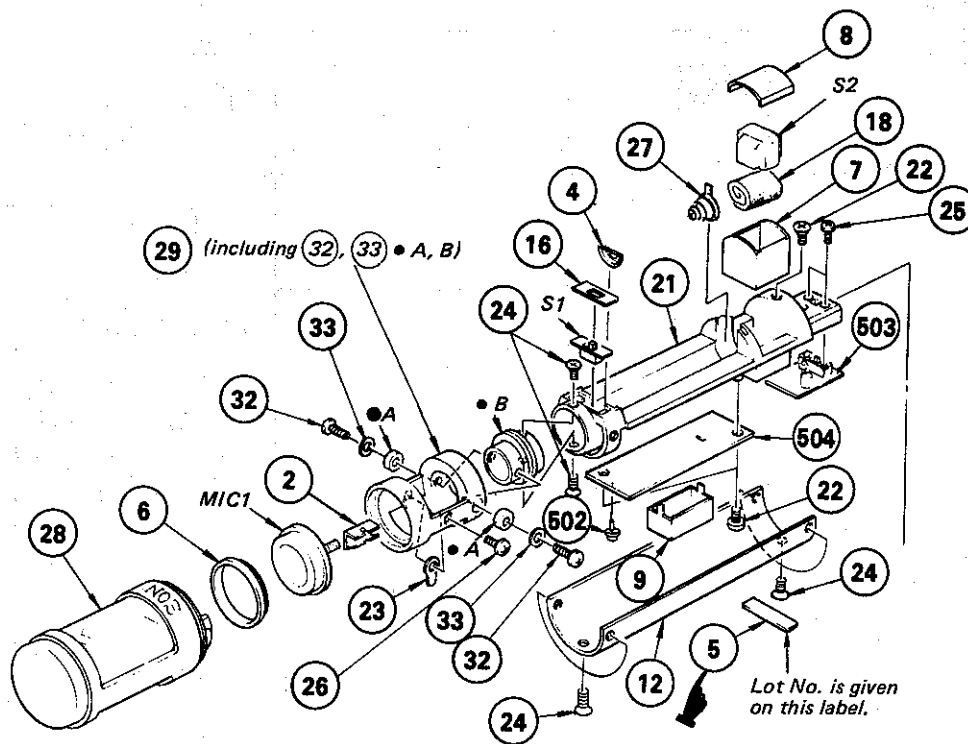

# CONDENSER MICROPHONE

# SONY®

## 3. MOUNTING DIAGRAM

— Conductor Side —

➤ : added portion

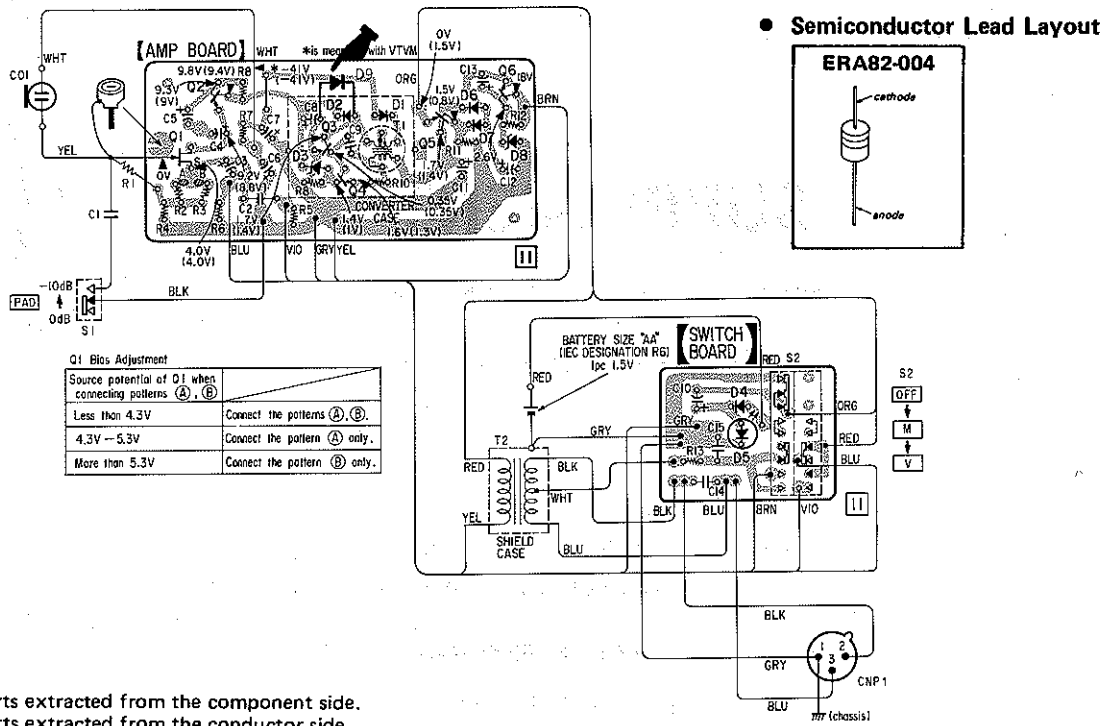

### ● Semiconductor Lead Layout

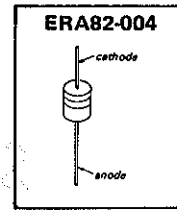

### Note:

- : parts extracted from the component side.
- : parts extracted from the conductor side.

## 4. SCHEMATIC DIAGRAM

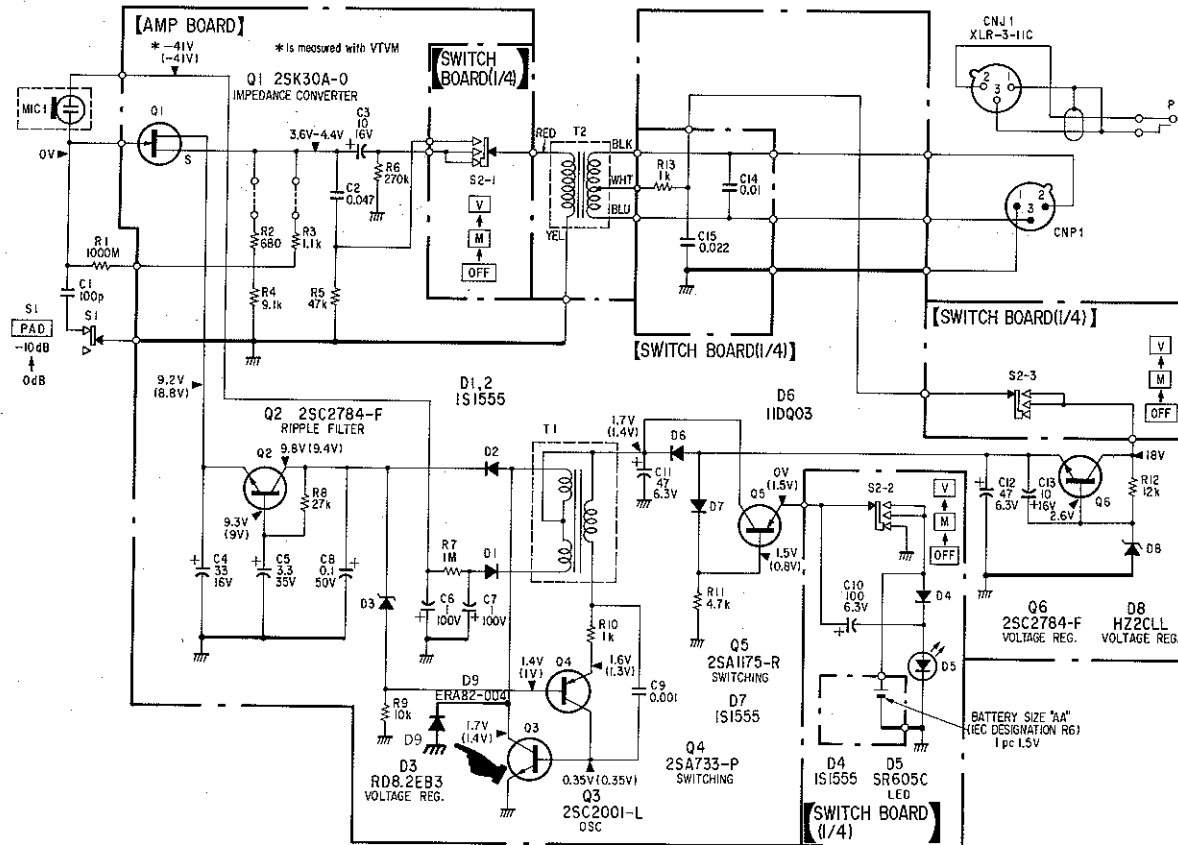

### Note:

- All capacitors are in  $\mu\text{F}$  unless otherwise noted.  $\text{pF}$ :  $\mu\text{pF}$
- 50WV or less are not indicated except for electrolytics and tantalums.
- All resistors are in  $\Omega$  and  $\frac{1}{4}\text{W}$  or less unless otherwise specified.
- Voltages are dc with respect to ground unless otherwise noted.
- Readings are taken under no-signal conditions with a VOM (50  $\text{k}\Omega/\text{V}$ ).
- ( ) : measured with dry battery.
- no mark: measured with external power supply.
- Voltage variations may be noted due to normal production tolerances.

Sony Corporation